

STATE OF MAINE
STATE HIGHWAY COMMISSION

PLAN AND PROFILE
STATE HIGHWAY "D"
DIXMONT
PENOBSCOT COUNTY

U.S. WORKS PROGRAM HIGHWAY PROJECT No. W.P.S.S. 236-D

TOTAL LENGTH 0.752 MILES

SCALES { PLAN 1 IN. = 50 FT.
 { PROFILE { HOR. 1 IN. = 50 FT.
 { VER. 1 IN. = 5 FT.
 { CROSS SECTIONS 1 IN. = 5 FT.

CONVENTIONAL SIGNS	
STATE OR NATIONAL LINE	SURVEY LINE
COUNTY LINE	CULVERT
TOWN LINE	DROP INLET
UNFENCED PROPERTY	TROLLEY POLE
FENCE	POWER POLE
RIGHT OF WAY LINE	TEL. POLE
TRAVELED WAY	MARSH
RAILROAD	TREES
RETAINING WALL	STONE WALL

INDEX OF SHEETS		
SHEET No.	1	TITLE PAGE
SHEET No.	2	TYPICAL SECTIONS
SHEET No.	3-4	PLAN AND PROFILE
SHEET No.	5-7	CROSS-SECTIONS
SHEET No.		BRIDGES
SHEET No.		SPECIAL DETAILS

} Sta. 73+0 to 93+50

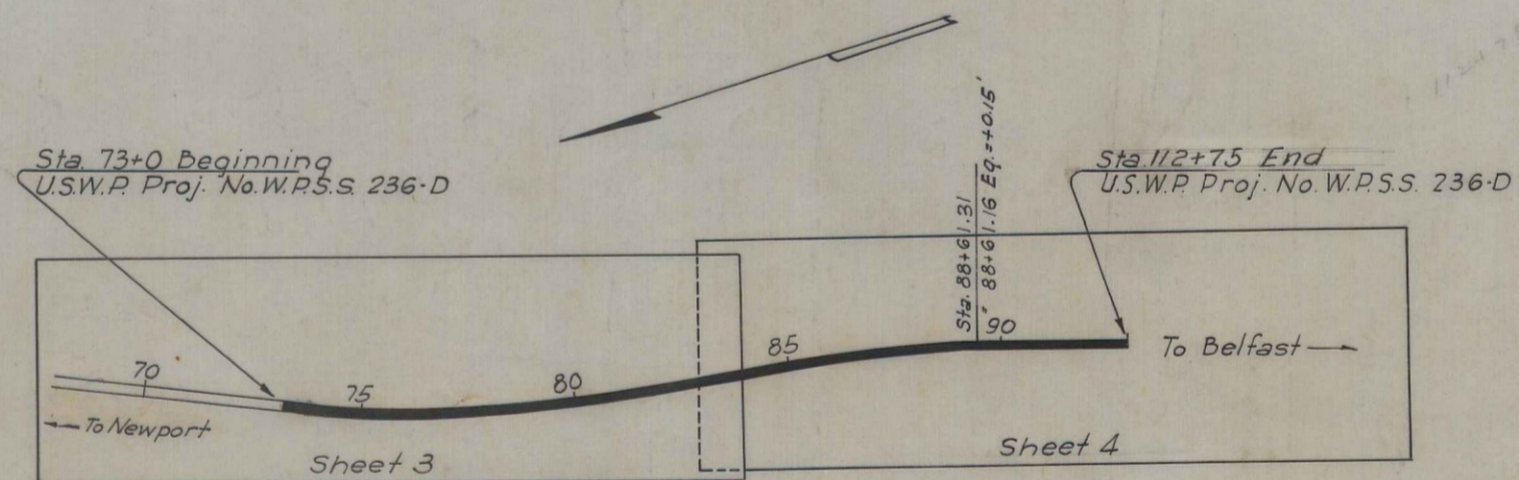

LAYOUT PLAN
Scale 1" = 300'

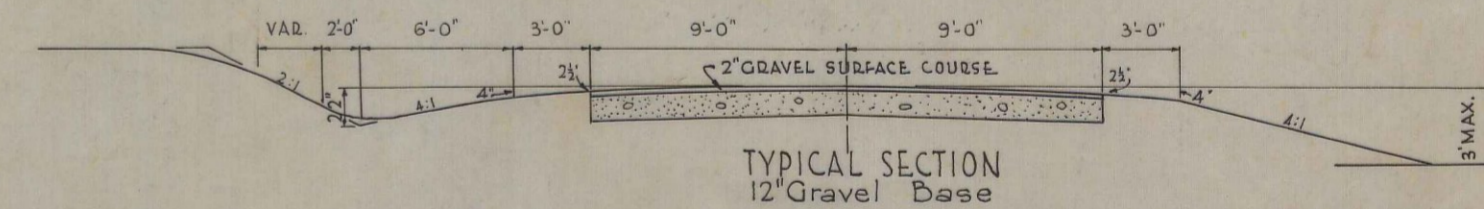

TYPICAL SECTION
12" Gravel Base

APPROVED:
MAINE STATE HIGHWAY COMMISSION

Paul C. Kunitz
CHAIRMAN

Sheldon

William J. Sumner
CHIEF ENGINEER

APPROVED:
U. S. BUREAU OF PUBLIC ROADS



A PORTION OF PENOBSCOT COUNTY
Scale 1" = 1 mile (approx.)

All work contemplated under this contract to be governed by and in conformity with the specifications adopted Sept. 20, 1935 unless otherwise specified on these plans.

2" GRAVEL SURFACE COURSE

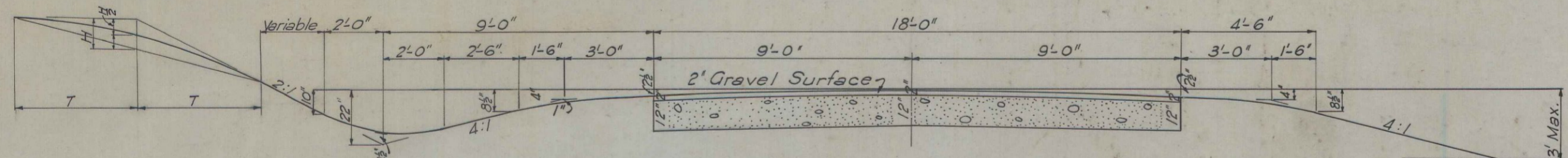

For all sections depth of ditch and length of curve at top of slope depend on local conditions. Use longest curve practicable, T being 2 ft. minimum and 5 ft. maximum.

12" GRAVEL BASE
 2" Gravel Surface Course = 11.11 C.Y. per 100 Lin. Ft.
 12" Gravel Base Course = 68.75 C.Y. per 100 Lin. Ft.

ESTIMATED QUANTITIES		
ITEM	DESCRIPTION	QUANTITY
11	Clearing & Grubbing	0.3 acres
12A	Earth Excavation	1950 c.y.
12B	Rock Excavation	600 c.y.
12C	Trees Removed	10 Ea.
13	Excavation for Structures	50 C.Y.
17A	Common Borrow	10600 c.y.
23	Gravel Base Course	2,900 c.y.
27	Gravel Surface Course	430 c.y.
40A	12" C.M.P.	60 Lin. Ft.
40B	15" C.M.P.	84 Lin. Ft.
40C	18" C.M.P.	142 Lin. Ft.
40D	21" C.M.P.	42 Lin. Ft.
51A	Wire Cable Guard Rail	2,400 Lin. Ft.
51B	Anchorage	18 Each

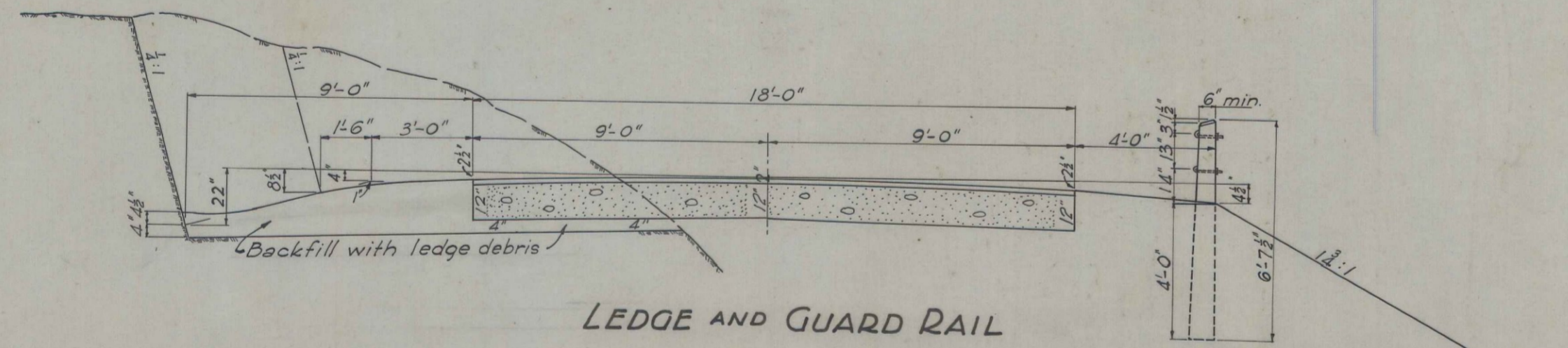

LEDGE AND GUARD RAIL

No top nor bottom rounding with 1 1/2:1 slope.

CULVERTS			
Sta.	Size	Kind	Remarks
87+90	12"x22"	C.M.P.	Driveway Left
89+50	12"x18"	C.M.P.	" Rt.
91+85	18"x52"	C.M.P.	
93+00	12"x20"	C.M.P.	Driveway Lt.

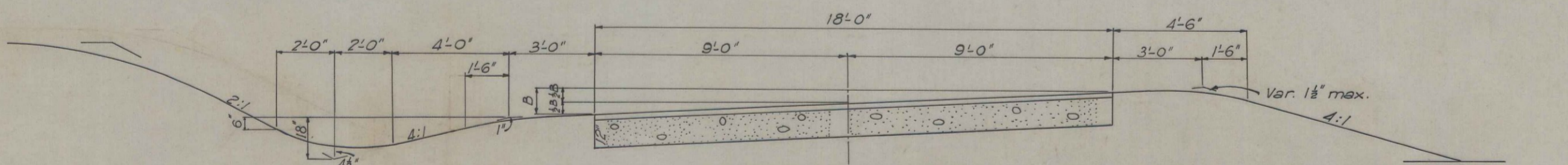

SUPERELEVATED CURVE

12" Gravel Base Course = 66.67 Cu. Yds. per 100 Lin. Ft.

Curves of 2° or more to be superelevated. "B", the full bank for 18 feet width, equals degree of curve times 2 with a minimum of 5" super-elevation and a maximum of 1" per foot width of pavement. All curves to have full super-elevation at approximately the P.C. & P.T. with a transition of 150' unless otherwise specified.

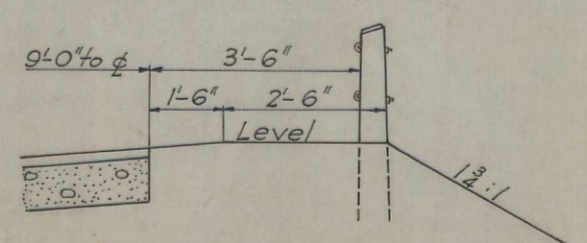

Linscott - Van 1736

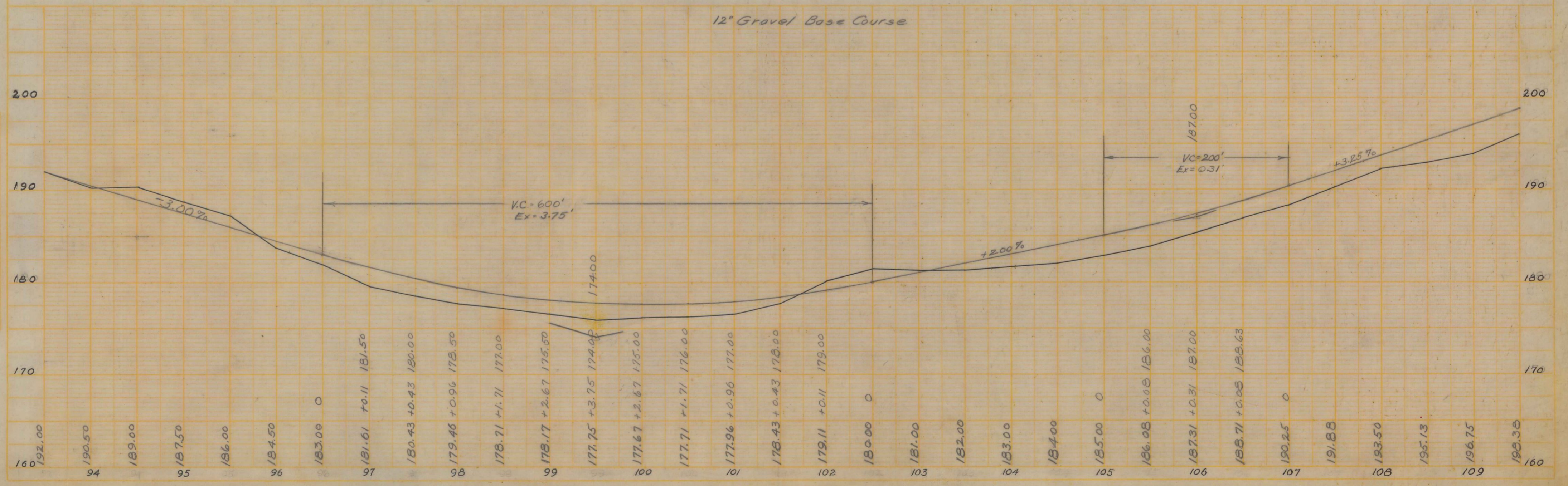
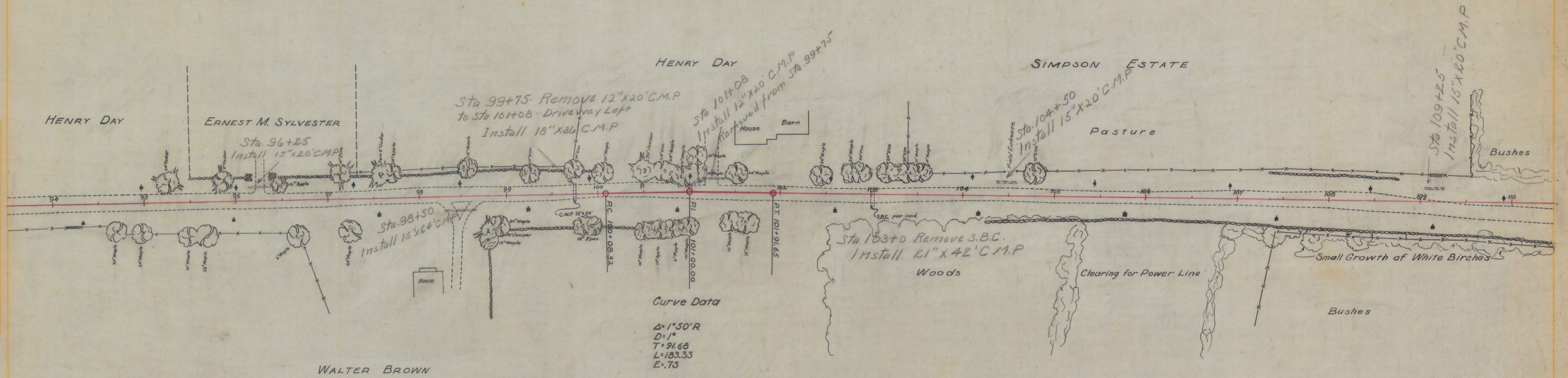

Acton L. McLaughlin, Aug. 1936
 Richard C. Hopkins

Richard C. Hopkins, Aug. 1936

Curve Data
 $\Delta = 15^{\circ}30' L$
 $D = 3'$
 $T = 259.92'$
 $L = 516.67'$
 $E = 17.63'$

Curve Data
 $\Delta = 6^{\circ}20' R$
 $D = 2'$
 $T = 158.50'$
 $L = 316.66'$
 $E = 4.38'$

