

# STATE OF MAINE DEPARTMENT OF TRANSPORTATION



## OLD ORCHARD BEACH

YORK COUNTY

ROUTE 5

STP-1863(600)

PROJECT LENGTH : 0.18 MILES

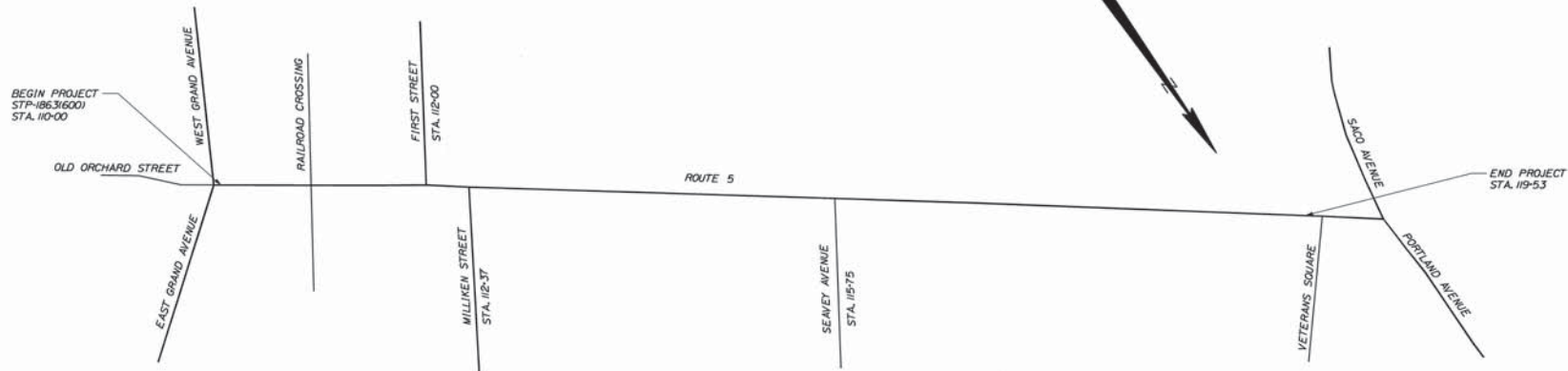

### TRAFFIC DATA

Current (2017) AADT	6840
Future (2029) AADT	7250
DHV - % of AADT	11%
Design Hour Volume	798
% Heavy Trucks (AADT)	5%
% Heavy Trucks (DHV)	5%
Directional Distribution (DHV)	59%
18 kip Equivalent P 2.0	154
18 kip Equivalent P 2.5	147
Design Speed (mph)	25
Functional Class	Major/Urban Collector
Highway Corridor Priority	4

<b>PROJECT LOCATION:</b>	Highway resurfacing beginning at East Grand Ave extending north 0.18 miles to Portland Ave.
<b>PROGRAM AREA:</b>	Highway Program
<b>SCOPE OF WORK:</b>	Mill and Fill

WIN 18636.00 STP-1863(600)

OLD ORCHARD BEACH  
ROUTE 5

TITLE SHEET

SHEET NUMBER

1

OF 1

STATE OF MAINE DEPARTMENT OF TRANSPORTATION	
APPROVED	DATE
COMMISSIONER	3/6/17
CHIEF ENGINEER	3-1-17



SIGNATURE	DATE
P.E. NUMBER	DATE
2/14/17	2/14/17

PROJECT INFORMATION	
PROGRAM	PROJECT MANAGER
DESIGNER	CONSULTANT
PROJECT RESIDENT	CONTRACTOR
PROJECT COMPLETION DATE	

**NOTE:**

1. THE PAVEMENT DEPTHS AS SHOWN ON THE PLANS ARE INTENDED TO BE NOMINAL.
2. WHEN SUPERELEVATION EXCEEDS THE SLOPE OF THE LOW SIDE SHOULDER, THE LOW SIDE SHOULDER SHALL HAVE THE SAME SLOPE AS THE TRAVELWAY.
3. CROWNS FOR BOTH NORMAL AND SUPERELEVATION SECTIONS FOR ALL COURSES PAVEMENT SHALL BE STRAIGHT.
4. THE ALGEBRAIC DIFFERENCE BETWEEN THE SHOULDER AND TRAVELWAY CROSS SLOPES "ROLLOVER" SHALL NOT EXCEED 8%.
5. THE STATIONING SHOWN UNDER EACH TYPICAL IS APPROXIMATE.

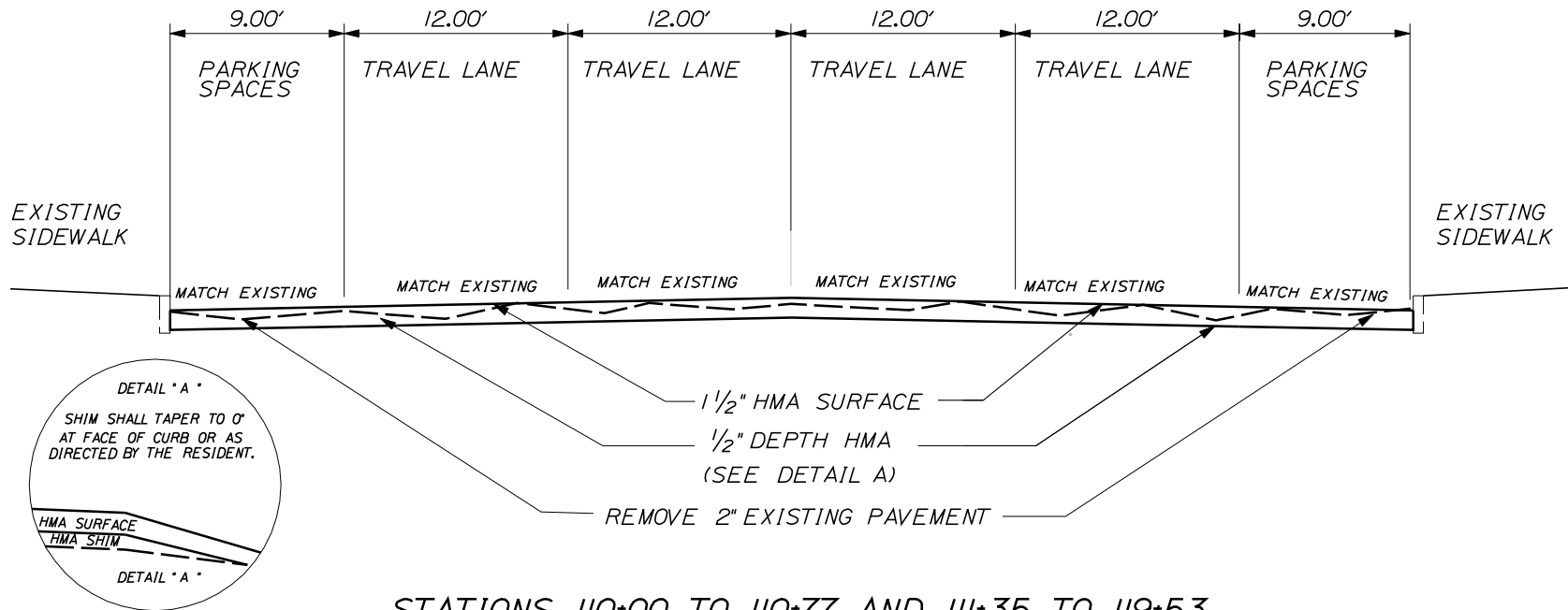
**2" MILL & FILL**

STATIONS 110+00 TO 110+77 AND 111+35 TO 119+53

NOT TO SCALE

STATE OF MAINE  
DEPARTMENT OF TRANSPORTATION

STP-1863(600)

WIN  
18636.00  
HIGHWAY PLANS

PROJECT NUMBER	DATE	BY	SIGNATURE
DESIGNED			
DRAWN			
CHECKED			
IN CHARGE			
REGION 1			
REGION 2			
REGION 3			
REGION 4			
REGION 5			
REGION 6			
REGION 7			
REGION 8			
REGION 9			
REGION 10			
REGION 11			
REGION 12			
REGION 13			
REGION 14			
REGION 15			
REGION 16			
REGION 17			
REGION 18			
REGION 19			
REGION 20			
REGION 21			
REGION 22			
REGION 23			
REGION 24			
REGION 25			
REGION 26			
REGION 27			
REGION 28			
REGION 29			
REGION 30			
REGION 31			
REGION 32			
REGION 33			
REGION 34			
REGION 35			
REGION 36			
REGION 37			
REGION 38			
REGION 39			
REGION 40			
REGION 41			
REGION 42			
REGION 43			
REGION 44			
REGION 45			
REGION 46			
REGION 47			
REGION 48			
REGION 49			
REGION 50			
REGION 51			
REGION 52			
REGION 53			
REGION 54			
REGION 55			
REGION 56			
REGION 57			
REGION 58			
REGION 59			
REGION 60			
REGION 61			
REGION 62			
REGION 63			
REGION 64			
REGION 65			
REGION 66			
REGION 67			
REGION 68			
REGION 69			
REGION 70			
REGION 71			
REGION 72			
REGION 73			
REGION 74			
REGION 75			
REGION 76			
REGION 77			
REGION 78			
REGION 79			
REGION 80			
REGION 81			
REGION 82			
REGION 83			
REGION 84			
REGION 85			
REGION 86			
REGION 87			
REGION 88			
REGION 89			
REGION 90			
REGION 91			
REGION 92			
REGION 93			
REGION 94			
REGION 95			
REGION 96			
REGION 97			
REGION 98			
REGION 99			
REGION 100			

OLD ORCHARD BEACH  
ROUTE 5

TYPICAL SECTIONS

SHEET NUMBER

1

OF 2

## 2" MILL & FILL SHOWING EXISTING CENTER ISLAND

### NOTE:

1. THE PAVEMENT DEPTHS AS SHOWN ON THE PLANS ARE INTENDED TO BE NOMINAL.
2. WHEN SUPERELEVATION EXCEEDS THE SLOPE OF THE LOW SIDE SHOULDER, THE LOW SIDE SHOULDER SHALL HAVE THE SAME SLOPE AS THE TRAVELWAY.
3. CROWNS FOR BOTH NORMAL AND SUPERELEVATION SECTIONS FOR ALL COURSES PAVEMENT SHALL BE STRAIGHT.
4. THE ALGEBRAIC DIFFERENCE BETWEEN THE SHOULDER AND TRAVELWAY CROSS SLOPES "ROLLOVER" SHALL NOT EXCEED 8%.
5. THE STATIONING SHOWN UNDER EACH TYPICAL IS APPROXIMATE

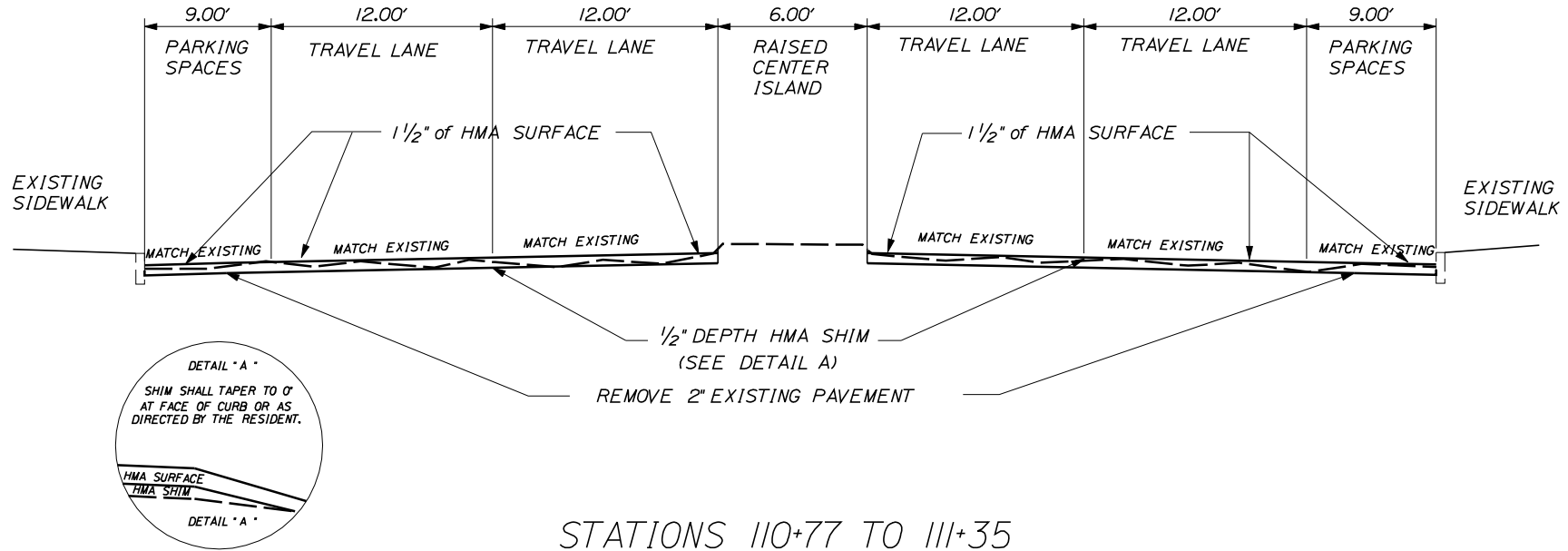

NOT TO SCALE

STATE OF MAINE  
DEPARTMENT OF TRANSPORTATION

STP-1863(600)

WIN 18636.00 HIGHWAY PLANS

OLD ORCHARD BEACH  
ROUTE 5

TYPICAL SECTIONS

SHEET NUMBER

2

OF 2

**STP-1863(600)**  
**18636.00**  
**Old Orchard Beach**  
**Route 5**  
**February 16, 2017**

**PROJECT STATIONING**

<b><u>Left Side</u></b>	<b><u>Station</u></b>	<b><u>Right Side</u></b>
End Project	119+53	End Project
	115+75	Seavey Street
	112+37	Milliken Street
First Street	112+00	
Begin Project	110+00	Begin Project

**CONSTRUCTION NOTES**

**202.202 REMOVING PAVEMENT SURFACE**

<b><u>Description</u></b>	<b><u>Station</u></b>
Begin	110+00
End	119+53

All millings/grindings shall become property of Maine DOT. The Contractor shall deliver and stockpile the millings/grindings at the Maine DOT maintenance facility on Route 202 located 0.14 mi. from Lyman-Hollis town line in Lyman, unless otherwise directed by the Resident. The payment for delivery and stockpiling will be incidental to item 202.202. Stockpiling shall include all equipment, personnel and all other necessary incidentals required to construct stockpiles as per normal construction practices.

**604.18 ADJUSTING CATCH BASIN OR MANHOLE TO GRADE**

<b><u>Left</u></b>	<b><u>Right</u></b>
111+87	116+29
111+89	117+77
	114+14
	119+35

**604.182 CLEAN EXISTING CATCH BASIN OR MANHOLE**

<b><u>Left</u></b>	<b><u>Right</u></b>
110+12	116+29
112+30	112+20
114+14	116+29
117+77	112+59
119+35	117+77
	114+14

**608.26 DETECTABLE WARNING FIELD**

<b><u>Left</u></b>	<b><u>Right</u></b>
111+84	112+24
112+24	112+52
112+39	112+67
115+45	115+45
116+11	115+63
	115+95
	116+11

**CONSTRUCTION NOTES**

**627.733 4" WHITE OR YELLOW PAINTED PAVEMENT MARKING LINE**

Final striping will not commence until 10 days have elapsed from the completion of surface pavement and must be completed within 20 days of the completion of surface pavement. Unless otherwise directed, failure to comply will result in a Traffic Control Violation.

Once Construction is Complete, Maintenance of Traffic Control Devices (652.36) will not be paid while waiting to final stripe.

Once Construction is Complete, Liquidated Damages will not be charged while waiting to final stripe

**627.75 WHITE OR YELLOW PAVEMENT & CURB MARKING**

**Rail Road Crossing Symbols**

<u>Station</u>	<u>Side</u>
110+68	RT
111+48	LT

**Crosswalk**

<u>Station</u>	<u>Side</u>
112+52	N/A
115+45	N/A
116+11	N/A

**Only Symbol**

<u>Station</u>	<u>Side</u>	<u>Quantity</u>
119+15	RT	2

**Arrows**

<u>Station</u>	<u>Side</u>	<u>Quantity</u>	<u>Type</u>
110+23	LT	2	Turn
110+85	LT	2	Turn
112+69	LT	2	Combo
118+85	RT	2	Turn
119+45	RT	2	Turn

**Only Symbol**

<u>Station</u>	<u>Side</u>	<u>Quantity</u>
119+15	RT	2

**CONSTRUCTION NOTES**

**627.78 TEMPORARY 4" PAINTED PAVEMENT MARKING LINE, WHITE OR YELLOW**

Temporary center lines shall be painted on all matched pavement within one week.

Temporary edge lines shall be painted on all pavement layers within four weeks.

All temporary lines shall be painted prior to final striping.

Multilane sections, truck lanes, and milled surfaces must be striped daily on all matched pavement layers.

TOMs must be used on all pavement layers until temporary paint is applied.

TOMs will be removed before final striping.

TOM removal will be addressed in the Traffic Control Plan.

Only painted temporary line will be paid under this item. TOMs will be considered incidental to the contract.